

CITY OF KEWANEE "DOWNTOWN" TIF DISTRICT MAP

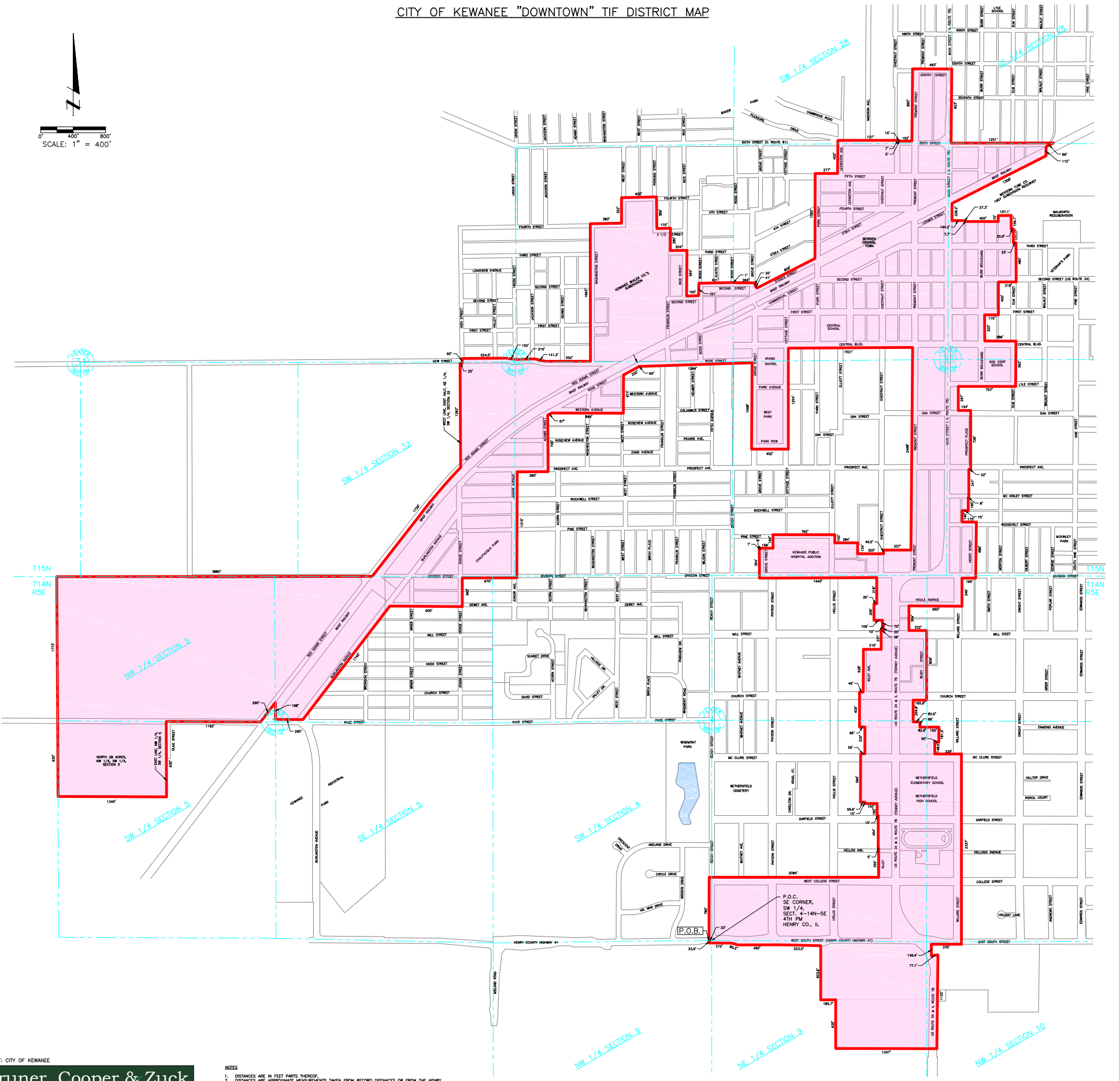
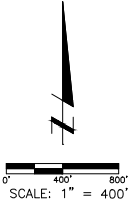

CLIENT: CITY OF KEWANEE

Bruner, Cooper & Zuck

Civil Engineers Structural Engineers Land Surveyors
 208 North 3rd Street Professional Design Firm 180 East Simmons Street
 Burlington, Iowa 52601 LS/PE/SE Corp. 184-002833 Oskawville, Illinois 61401
 319.752.8292 319.752.8292

NOTES

1. DISTANCES ARE IN FEET UNLESS OTHERWISE NOTED.
2. DISTANCES ARE APPROXIMATE MEASUREMENTS TAKEN FROM RECORD DISTANCES OR FROM THE HENRY COUNTY, ILLINOIS GIS MAP AND ALL COURSES ARE APPROXIMATE ORIGINAL COMPASS DIRECTIONS.
3. THIS MAP COMPILED FROM RECORDS.
4. P.O.B. DENOTES POINT OF COMMENCEMENT OF THE "DOWNTOWN" TIF LEGAL DESCRIPTION.
5. P.O.B. DENOTES POINT OF BEGINNING OF THE "DOWNTOWN" TIF LEGAL DESCRIPTION.

— INDICATES "DOWNTOWN" TIF DISTRICT FOR THE CITY OF KEWANEE.

--- INDICATES QUARTER SECTION LINE.

JOB NO. 2014213 | DATE: 09/12/2014 | DRAWN: TLG | CHECKED: JAS | APPROVED: KJC